

Half Weight Rack Hanging Instructions

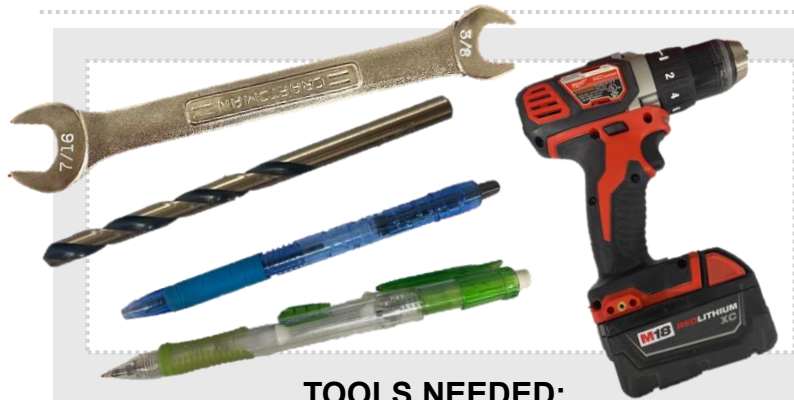

3003 9th Ave. SW • Watertown, SD 57201
1-800-743-7738 • info@PivotalHealthSolutions.com
www.TeamEdgeAthletics.com



TOOLS NEEDED:
7/16” Wrench, Drill, 7/32” Drill Bit, Stud Finder,
Marker/Pencil

IN THE BOX:

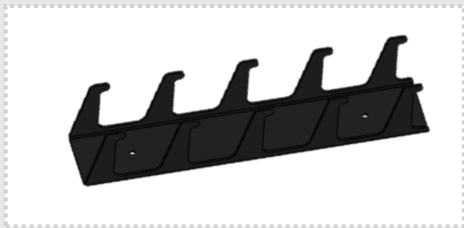

(1) Half-Weight Rack



(3) Washers



(3) Screws

Weight Rack (Front View)



Screws
&
Washers

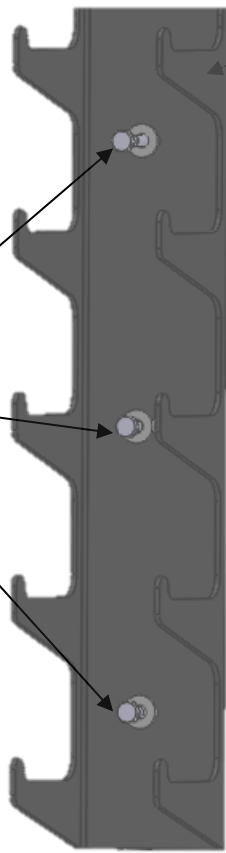

Half Weight Rack

Weight Rack Hanging Instructions



1. Unpack weight rack, washers and screws from box. Use a stud finder to locate a stud in the wall.

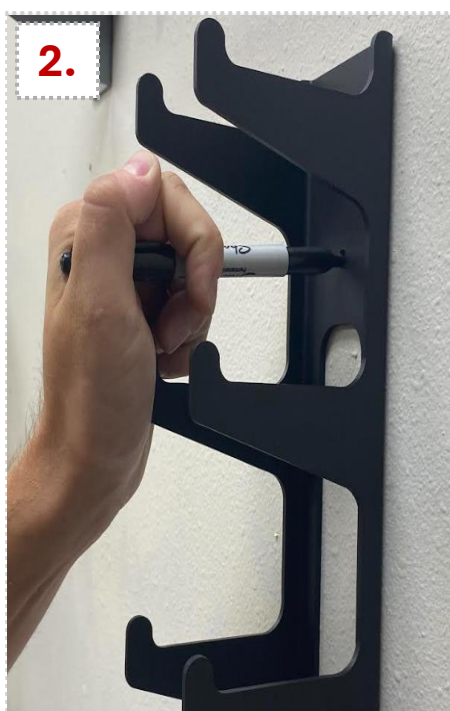

2. Line weight rack up on the wall where the stud was located and use a marker or pencil to mark the center of the hole.



3. Drill three small pilot holes on the locations you marked with a 7/32in drill bit.



4. Line up the holes in the weight rack with the pre-drilled holes. Using a 7/16in wrench or socket drive bit, install the three screws and three washers provided into the pre-drilled holes. One screw and washer per-hole. Repeat this process for all three holes.

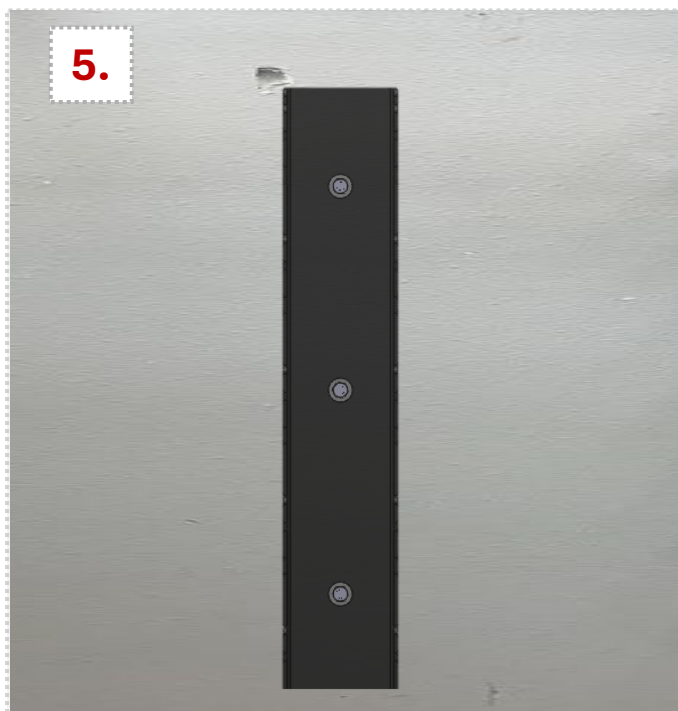

Your Weight Rack is now ready for use.

*Note: Routinely check weight rack to make sure all hardware is tight and tighten accordingly when necessary.